

ITEM	PART NO.	DESCRIPTION	QTY.	WEIGHT
1	MT500GDP	STANDOFF BRACKET	2	0.28 LBS
2	DPA141ZP	6.5 x 25mm DRIVE PIN ANCHOR	4	0.02 LBS
3	MT520	INSULATOR W/ 3/8"-16 UNC THREADED INSERT	2	0.21 LBS
4	SB-0305	3/8"-16 UNC X 5/8" SS HEX BOLT	4	0.04 LBS
5	SWL-03	3/8" SS LOCK WASHER	4	0.01 LBS
6	45840G-1	GALV. ANGLE ADAPTOR	2	0.41 LBS
7	SB0316#4	3/8"-16 UNC X 1-3/4" S.S. SQUARE HEAD SET SCREW	2	0.05 LBS

REVISIONS				
REV.	ZONE	DESCRIPTION	BY	DATE
A		INITIAL RELEASE	ACG	03/16/10
B		UPDATE BRACKETS & ANGLE ADAPTORS	ACG	11/23/11
C		UPDATE ITEM #1	ACG	03/02/12

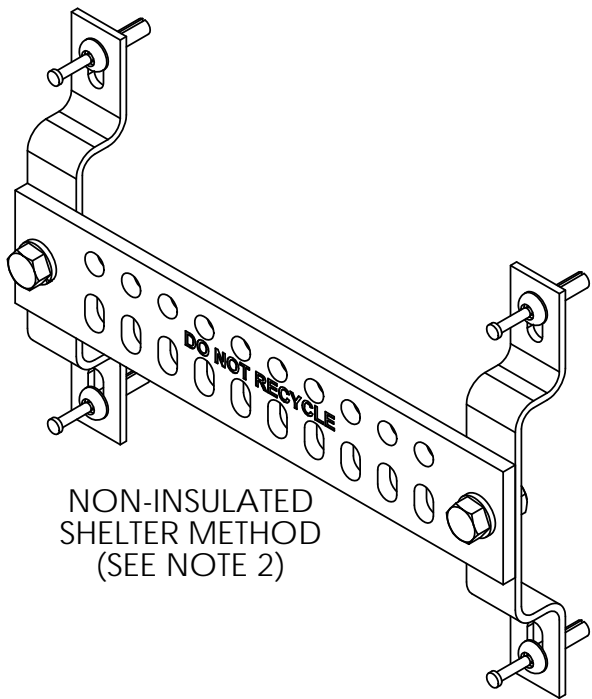
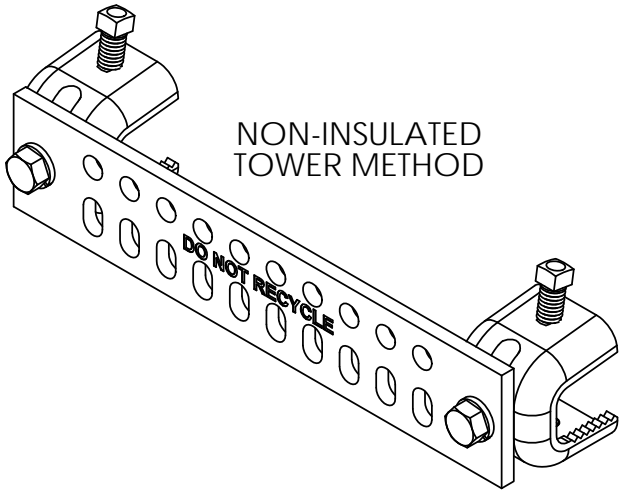
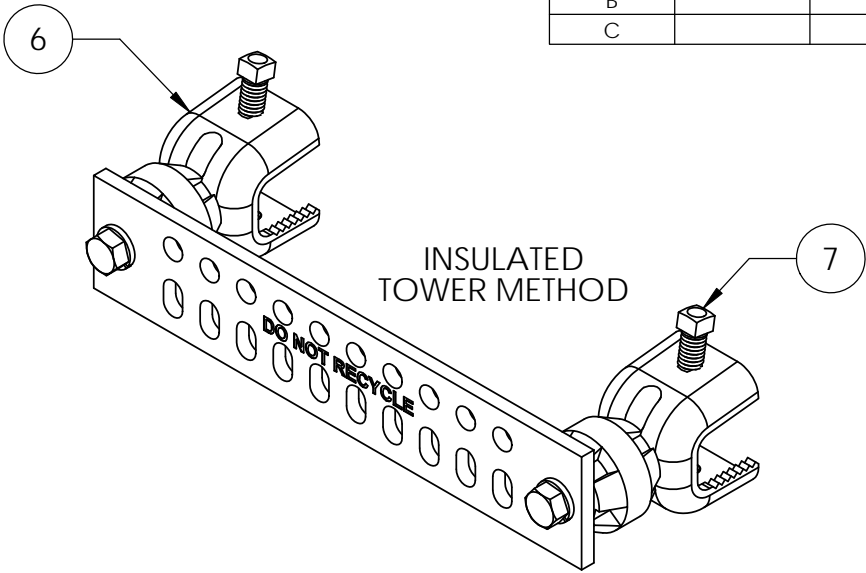
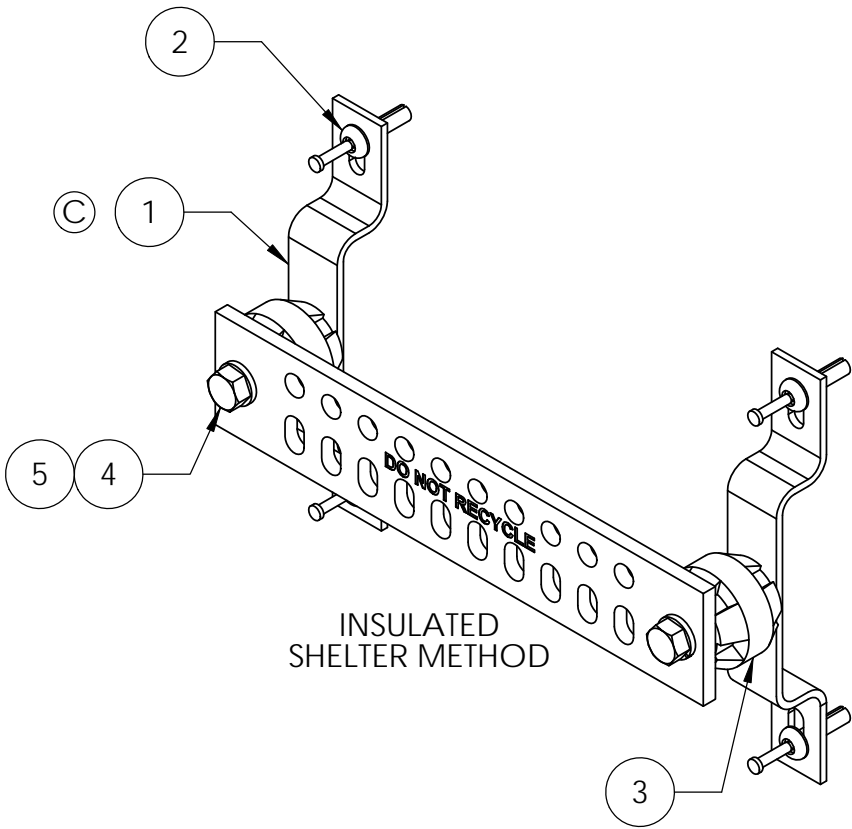

NOTES:
1. BUSS BAR NOT INCLUDED (SHOWN FOR CLARITY).
2. ORDER 3/8" SS NUTS SEPERATELY FOR NON-INSULATED SHELTER METHOD.

These drawings and specifications are the proprietary property and may be used only for the specific purpose authorized in writing.	DRAWN BY:	ACG	SHEET:	1 of 1	PART NUMBER:	GB-HK-DPU
	CHECKED BY:	CC	SCALE:	NTS	DESCRIPTION:	UNIVERSAL BUSS BAR KIT
	DATE:	03/16/10	MATERIAL:	N/A	DRAWING TYPE:	ASSEMBLY DRAWING
	REVISION:	C	FINISH:	N/A		
	DO NOT SCALE THIS PRINT		WEIGHT:	5.72 LBS		